

The **R Series** provides ultimate flexibility with sub-ports that can be fitted with a variety of compact flow meters, flow controllers and shut-off valves.

Manifold Assembly Components

3 Ports

Female / Female

RF3

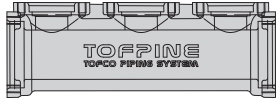

TPM25: 1" TPM32: 1¼"

2 Ports

Female / Female

RF2

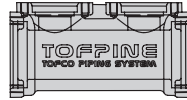

TPM25: 1" TPM32: 1¼"

1 Port*

Female / Female

RFD

Above
OR
Below

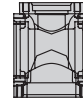

TPM25: 1" TPM32: 1¼"

1 Port*

Female / Female

RFB

Front
OR
Back

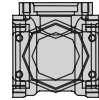

TPM25: 1" TPM32: 1¼"

3 Ports

Female / Male

RM3



TPM25: 1" TPM32: 1¼"

2 Ports

Female / Male

RM2



TPM25: 1" TPM32: 1¼"

1 Port*

Female / Male

RMD

Above
OR
Below



TPM25: 1" TPM32: 1¼"

1 Port*

Female / Male

RMB

Front
OR
Back

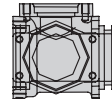

TPM25: 1" TPM32: 1¼"

* Single-port manifold segments provide a right-angle inlet/outlet connection.

Main Port Components

Adapter

With mounting feet

A

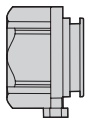

A04: ¾" RC A05: 1" RC
A05: 1" RC A06: 1¼" RC
AN4: ¾" NPT
AN5: 1" NPT

Adapter

Without mounting feet

S

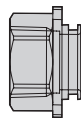

For use with inlet/outlet on single-port segments only.
S04: ¾" RC S05: 1" RC
S05: 1" RC S06: 1¼" RC

Plug

With mounting feet

P

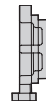

TPM25 TPM32

Mounting Bracket

Includes M4 x 16 screws

B



TPM25 TPM32

O-Ring (FPM)

O



G30 G35

Hexagon Bolt

N



N: M4 x 14 N: M4 x 14
NS: M4 x 12 For use with single-port adapters only.

Note: A 3mm short-head Allen wrench (hex key) is required for manifold assembly and will be provided free of charge upon request.

Let us configure a manifold with you!

Proteus applications specialists are available to work with you to help select the necessary components to create a Tofpine manifold configuration that will enable you to achieve your exact flow measurement and control requirements. Contact us at (650) 964-4163 or sales@proteusind.com for immediate assistance.

▼ HC Series

The **HC Series** features sub-ports with integrated flow sensors that can be fitted with optional digital displays, analog converters and shut-off valves.

Manifold Assembly Components

3 Ports

Female / Female

HF3

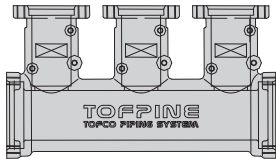

TPM25: 1" TPM32: 1¼"

2 Ports

Female / Female

HF2

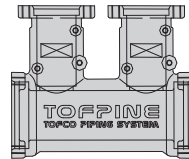

TPM25: 1" TPM32: 1¼"

1 Port*

Female / Female

HFD

Above
OR
Below

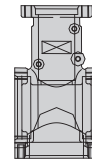

TPM25: 1" TPM32: 1¼"

1 Port*

Female / Female

HFB

Front
OR
Back

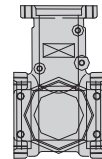

TPM25: 1" TPM32: 1¼"

3 Ports

Female / Male

HMB

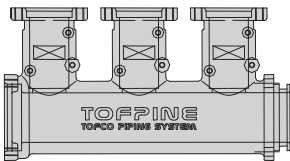

TPM25: 1" TPM32: 1¼"

2 Ports

Female / Male

HM2

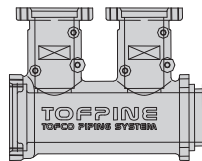

TPM25: 1" TPM32: 1¼"

1 Port*

Female / Male

HMD

Above
OR
Below

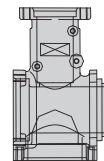

TPM25: 1" TPM32: 1¼"

1 Port*

Female / Male

HMB

Front
OR
Back

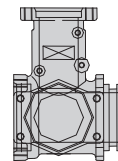

TPM25: 1" TPM32: 1¼"

* Single-port manifold segments provide a right-angle inlet/outlet connection.

Main Port Components

Adapter

With mounting feet

A

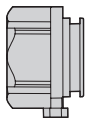

A04: ¾" RC A05: 1" RC
A05: 1" RC A06: 1¼" RC
AN4: ¾" NPT
AN5: 1" NPT

Adapter

Without mounting feet

S

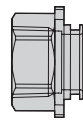

For use with inlet/outlet on single-port segments only.
S04: ¾" RC S05: 1" RC
S05: 1" RC S06: 1¼" RC

Plug

With mounting feet

P

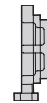

TPM25 TPM32

Mounting Bracket

Includes M4 x 16 screws

B



TPM25 TPM32

O-Ring (FPM)

O



G30 G35

Hexagon Bolt

N



N: M4 x 14 N: M4 x 14
NS: M4 x 12 For use with single-port adapters only.

Note: A 3mm short-head Allen wrench (hex key) is required for manifold assembly and will be provided free of charge upon request.

Note: To enable the calibration of the flow metering devices contained within HC Series manifold segments, Tofpine manifolds featuring integrated flow metering elements are only available for purchase as complete assemblies. R Series manifold segments and common Tofpine components may be purchased individually for use with external flow measurement and control devices. For applications assistance, please contact Proteus Industries at (650) 964-4163 or sales@proteusind.com.

Sub-Port Components

Adapter A

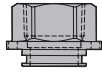

- A01: ¼" RC A03: ½" RC
- A02: ⅜" RC A04: ¾" RC
- A03: ½" RC AR4: ¾" R
- AR1: ½" R
- AN1: ¼" NPT
- AN2: ⅜" NPT
- AN3: ½" NPT

Ball Valve V



- V02: ⅜" RC V03: ½" RC
- V03: ½" RC V04: ¾" RC

FLC Adapter F

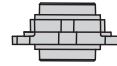

For FLC600 Series Flow Controller

TPM25

FLC Adapter F

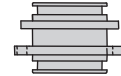

For FLC700 Series Flow Controller

TPM32

Plug P



TPM25 TPM32

O-Ring (FPM) O



P20 P24

Hexagon Bolt N



M4 x 8 M4 x 12

Manifold Specifications

	TPS25 Model	TPS32 Model
Inner Diameter	25 mm / 1"	32 mm / 1¼"
Flow Capacity	200 LPM / 53 GPM	300 LPM / 79 GPM
Max. Liquid Temperature	100°C / 212°F	
Max. Operating Pressure	1 MPa / 145 PSI (Range may be restricted by flow meter selection)	
Wetted Materials	Manifold: 304 Cast Stainless Steel / O-Ring: FPM (Viton®)	

HC Series Integrated Flow Metering Capabilities

	TPS25 Model				TPS32 Model	
Connection Size	¼" RC / NPT	⅜" RC / NPT	½" RC / NPT	½" R	½" RC	¾" RC
Flow Range (LPM)	0.5 – 5	1 – 10	2 – 20		3 – 30	5 – 50
Flow Range (GPM)	0.13 – 1.3	0.26 – 2.6	0.53 – 5.3		0.79 – 7.9	1.3 – 13.2
Flow Accuracy	± 5% at full scale					
Available Outputs	Pulse	Digital Display	4 – 20 mA	0 – 5 VDC	0 – 10 VDC	1 – 5 VDC 1 – 10 VDC
Max. Liquid Temperature	80°C / 176°F		50°C / 122°F			
Pulse Output	NPN Open Collector		26.4 VDC	15 mA Max.	0 ~ 140 Hz	
Supply Voltage	5–24 VDC ± 10%					

EXCEPTIONAL FLOW COMPONENTS BY **TOFCO** WORLD-CLASS SUPPORT BY **Proteus**



Proteus Industries Inc.
 340 Pioneer Way, Mountain View, CA 94041
 Tel: (650) 964-4163 Fax: (650) 965-0304
 www.proteusind.com sales@proteusind.com

Information in this document was correct at the time of printing; however, specifications are subject to change as Proteus Industries' continuous improvement processes establish new capabilities.

© Proteus Industries Inc.

TPSCL Rev 004 03/2009