

TOFPINE

TOFCO PIPING SYSTEM



TOFPINE is a revolutionary new configurable manifold system for liquid measurement and control. Multiple manifold segments mate with flow meters, flow controllers and shut-off valves to create flow management systems customized to your exact requirements.

■ Features

- Ultimate freedom of design
- Small footprint, minimized volume
- Simplifies liquid distribution
- Integrate flow meters, flow controllers & valves
- Flow rates to 200 LPM (53 GPM) and 300 LPM (79 GPM)
- No welds – Create and design as you go!



► Scalable

Manifold segments of varying lengths and numbers of sub-ports can be joined together in various combinations to meet the exact performance and space requirements of your flow system. TOFPINE's revolutionary design enables the compact incorporation of any number of components and greatly simplifies liquid distribution by eliminating nipples and elbows.



► Metering Capability

Miniature flow sensors provide sensitive and accurate flow measurement at each sub-port. Flow rates from 0.5 to 20 LPM (0.13 to 5.3 GPM) with a 1" manifold and 3 to 50 LPM (0.79 to 13.2 GPM) with a 1¼" manifold. Available options include digital displays for local indication of flow rate and analog converters for outputs in 4–20 mA or voltage formats.



► Flow Control Capability

Available fast, responsive PID controllers with integrated flow sensors enable precise programmable control at selected flow rates. Analog outputs and dual programmable alarm flows can be linked to external devices. Digital displays provide local indication of instantaneous or preset flow rates for each sub-port.



► Shut-Off Capability

Manifold sub-ports can be fitted with manual or solenoid shut-off valves to enable rapid and complete stoppage of liquid flow. Valves can be fitted on both the supply and return lines to allow the complete isolation of the flow circuit for maintenance or replacement of system components.

Manifold System

▼ R Series

The **R Series** provides flexibility with sub-ports that can be fitted with a variety of components such as flow meters, flow controllers and shut-off valves.

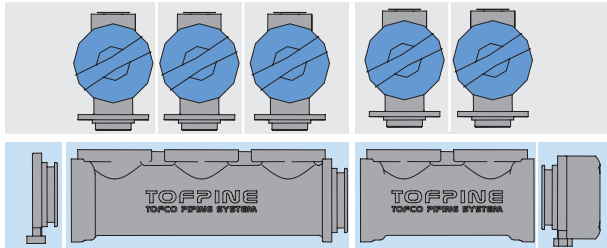

▼ HC Series

The **HC Series** features sub-ports with integrated flow sensors that can be combined with analog converters and manual shut-off valves.

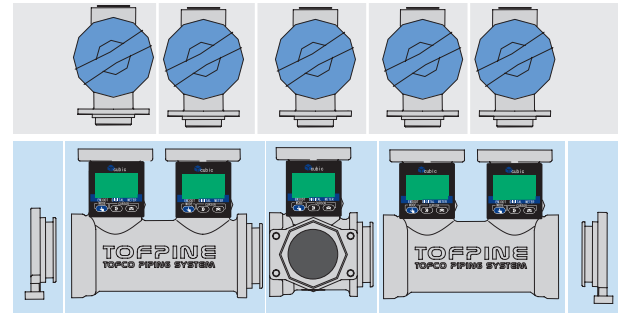

Manifold Specifications

	TPS25 Model	TPS32 Model
Inner Diameter	25 mm / 1"	32 mm / 1¼"
Flow Capacity	200 LPM / 53 GPM	300 LPM / 79 GPM
Max. Liquid Temperature	100°C / 212°F	
Max. Operating Pressure	1 MPa / 145 PSI (Range may be restricted by flow meter selection)	
Wetted Materials	Manifold: 304 Cast Stainless Steel / O-Rings: FPM (Viton®)	

HC Series Integrated Flow Metering Capabilities

	TPS25 Model	TPS32 Model
Flow Range	0.5 – 20 LPM / 0.13 – 5.3 GPM	3 – 50 LPM / 0.79 – 13.2 GPM
Max. Liquid Temperature	Temperature limit is dependent on flow metering capability.	
Available Outputs	Pulse • Digital • 4–20 mA • 0–5 VDC • 0–10 VDC • 1–5 VDC • 1–10 VDC	



Discover how the TOFPINE manifold system can enable you to achieve your exact flow measurement and control requirements! If you are using multiple flow sensing devices in your system and are concerned about reducing costs and space, contact a Proteus applications specialist for further information.

EXCEPTIONAL FLOW COMPONENTS BY **TOFCO** WORLD-CLASS SUPPORT BY **Proteus**



Proteus Industries Inc.
340 Pioneer Way, Mountain View, CA 94041
Tel: (650) 964-4163 Fax: (650) 965-0304
www.proteusind.com sales@proteusind.com

Information in this document was correct at the time of printing; however, specifications are subject to change as Proteus Industries' continuous improvement processes establish new capabilities.

© Proteus Industries Inc.

TPSDS Rev 003 03/2009